

# Smart Wifi LED Strip Lights Works with Alexa

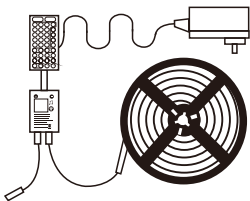

User Manual

# User's Manual

## Product Overview

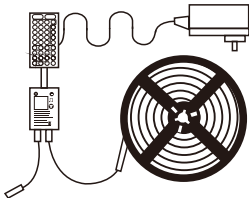

1. Built-in MEMS microphone, real-time acquisition of music and environmental sound intensity
2. LED Strip Light sync to music , contains a variety of musical rhythm modes
3. Infrared Remote Controller Control(Optional)
4. Press key to switch mode and color
5. Control by SmartLife APP
6. Works with Amazon alexa and Google home and so on

## Product Parameter

Category	LED Strip Lights
Domination Principle	WiFi
APP	SmartLife
Operation Platform	Android4.0 or IOS9.0orhigher
Sound Sensor	MEMS MIC
LED Drive Type	Constant voltage : MOSFET
Channels	3
Input Voltage	DC ( 4.5-25 ) V

## WiFi Controller Box

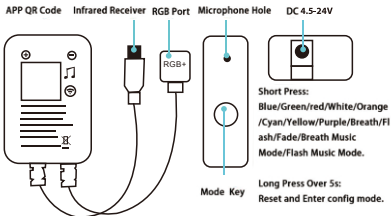

## IR Remote Controller

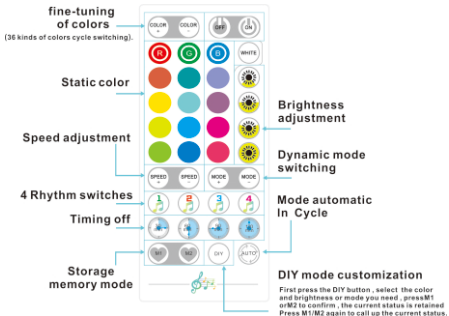

## How to install

1. Prepare **all** the required accessories before you begin the installation.
2. Peel off the adhesive strip from the back side of the LED STRIP LIGHT.

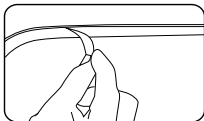

3. Stick the LED STRIP LIGHTS on an even surface.
4. Connect the pins of LED STRIP LIGHTS into socket of the control box ( both arrows pointing at each other). Beware of the polarity and direction of the pins of LED STRIP LIGHTS and socket of the control box. LED would not light up if it is not connected with correct polarity and direction.

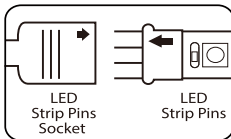

**Note:** Connect the LED strip pins socket and the LED strip pins, where both **arrows are pointing at each other**

5. The sensor of the Infrared (IR) receiver must be placed at the visible range and should be less than 5M from the remote control. The round face of the IR sensor should be faced to remote control without obstacles.

### Infrared (IR) Receiver

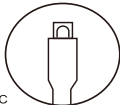

6. Connect the DC plug of the USB cable into DC socket of the Control Box.
7. Connect the USB 2.0 Plug of USB cable into USB socket of your TV or USB outlet of AC adapter (not included)

## Batteries Installation for Remote control

Button cell battery (CR2025) is installed in the remote control. Pull out the PVC plate from battery door for the contact of battery before use.

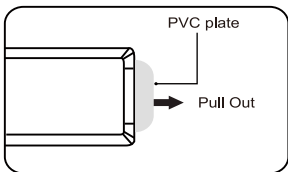

### To replace/ install a new battery into the remote control:

If the remote control is not operating properly or not responding at all, the battery may be exhausted. Follow the below instruction to replace a new battery. Open the battery door follow the instruction diagram on the back side of the remote control. Insert 1x button cell battery (CR2025). Battery should be placed as shown on the diagram below.

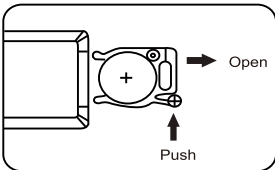

Max Output Power	144W
Work For	LED Strip or other constant voltage lights
Connect Method	Common Anode
IP Rating	IP20
Control Distance	Visible distance 30M

## Software Manual

### Download and Install App

Use your phone to scan the QR code below or search "Smart Life" in application marker to Download and install the App



### Register/Login/Forget password

**Register:** Register your account to the following tips before using at the first time. If you have an account, please enter the password to login directly.

**Login:** Input the correct account number and password to login.

**Forgert your password:** You can enter the login page to retrieve your password.

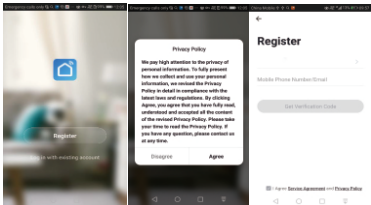

## Add Device-Normal mode

In the main application page,click on the top right corner "+" to next window page and then choose Lighting,as shown below.

In normal mode,please confirm that the device red light is quickly blink and then into the next step.

### Note:

If the light is not flash,press the "mode" key of the controller with 5-10 seconds to keep the red light in the quickly blink for searching & connecting network.

If add the device in Normal mode fails many times,please go to [Add Device-AP mode](#)

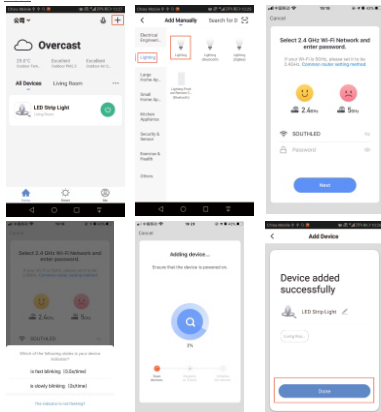

## Add Device-AP mode

In the main application page,click on the top right corner "+" to next window page and then choose Lighting,as shown below.

In normal mode, click on the top right corner "AP Mode" to AP Mode window page.

In AP Mode,please confirm that the device red light is slowly blink and then into the next step.

### Note:

If the light in quickly blink,just press the controller with 5-10 seconds again,and the red light will slowly blink,

If the light neither slowly blink nor quickly blink,First press the "mode" key of the controller with 5-10 seconds to keep the red light in the quickly blink ,Second release the button and then press the controller with 5-10 seconds again,the red light will slowly blink.

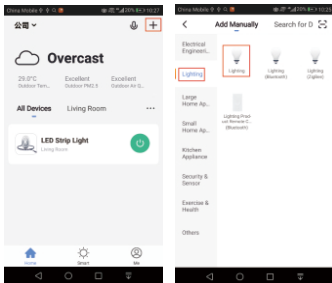



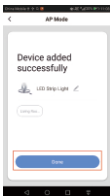
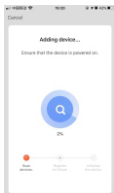
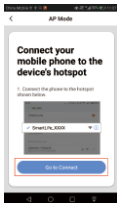
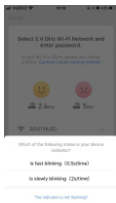
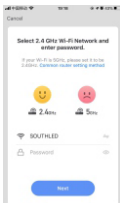

## Control device

After successfully connecting the devices, the related smart device will be shown on the home page. Tap to enter its control page

**Note:**

1. when device is online, it supports quick operations
2. when device is offline, it displays "Offline", and can not be controlled.

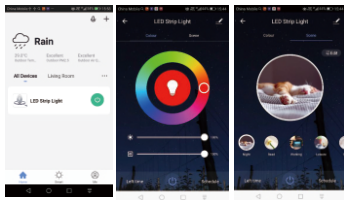

## LED Strip Light Sync to Music Function

Enter music mode and play music with any device, and the led strip light will sync to music

**Note:**

The volume of mobile phone is relatively small, it's better to use Bluetooth audio

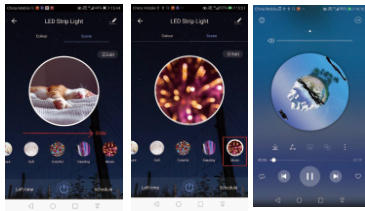

1. Click Edit in the top right corner to enter custom scene
2. Breath and Static music mode is suitable for light music
3. Flash music mode is suitable for fast rhythm music
4. You can add/delete/modify the color displayed and change the speed of color switching
5. If you are not satisfied, you can reset the settings

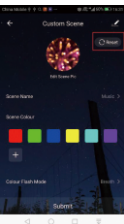
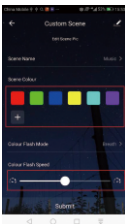
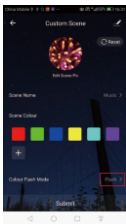
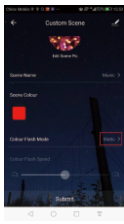
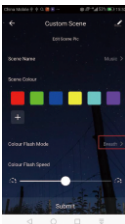
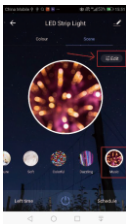

## Works with Amazon Alexa

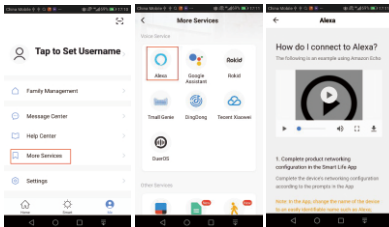

## Works with Google Assistant

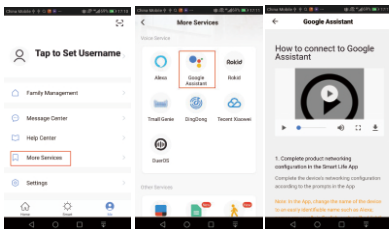

## FAQ

1.How to reset the controller?

Press the "mode" key of the controller with 5-10 seconds

2.How to get more help?

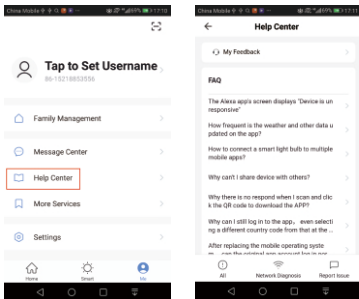

## Attentions

1. Please use the product in a dry environment.
2. Please use the input voltage at 4.5-25V DC voltage, must not connect into 220V AC directly.
3. The product is requested common anode connection. The wrong connection will cause a malfunction.
4. In the process of the product and software upgrade, the data and software interface listed in the text are only for description and reference. No further notify will given if there is any change.

## Benutzerhandbuch

### Produktübersicht

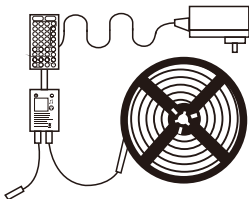

1. Eingebautes MEMS-Mikrofon, Echtzeiterfassung von der Musik und Umgebungsschallintensität.
2. LED Strip Light synchron zur Musik, enthält zahlige musikalischen Rhythmusmodi.
3. Infrarot-Fernbedienung (optional).
4. Tastatur kontrolliert Farbe und Modus.
5. Steuerbar über die SmartLife APP.
6. Kompatibel mit Amazon Alexa und Google Home.

### Produkt Parameter:

Kategorie	LED Strip Lights
APP	Smart Life
Sprache	Chinesisch, Englisch
Betriebsplattform	Android4.0 oder IOS9.0 or higher
Schallsensor	MEMS MIC
LED-Laufwerkstyp	Constant voltage:MOSFET
Eingangsspannung	DC(4.5-25)V
Max. Ausgangsleistung	144W
Verbindungsmethode	Common Anode
IP-Bewertung	IP20
Kontrollsdistanz	Sichtbare Distanz 30M

## WiFi Controller Box

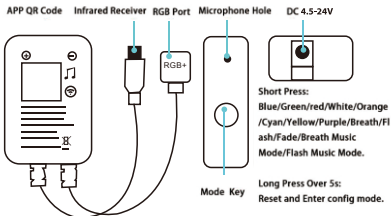

## IR Remote Controller

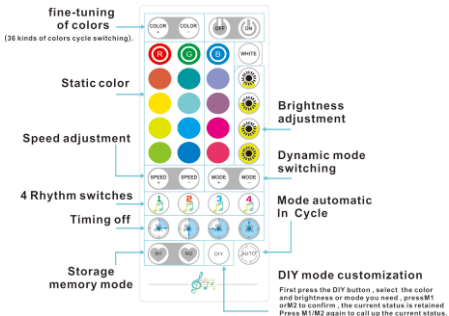

## Software-Handbuch

### App herunterladen und installieren

Scannen Sie mit Ihrem Handy den unten stehenden QR-Code oder suchen Sie in App Store nach „Smart Life“ zum Herunterladen und Installieren der App.



### Registrieren / Anmelden / Passwort vergessen

**Registrieren:** Registrieren Sie Ihr Konto anhand der folgenden Tipps, bevor Sie es beim ersten Mal verwenden.

Wenn Sie ein Konto haben, geben Sie bitte das Passwort ein, um sich direkt anzumelden.

**Login:** Geben Sie die richtige Kontonummer und das richtige Passwort ein, um sich anzumelden.

**Passwort vergessen:** Sie können die Anmeldeseite aufrufen, um Ihr Passwort abzurufen.

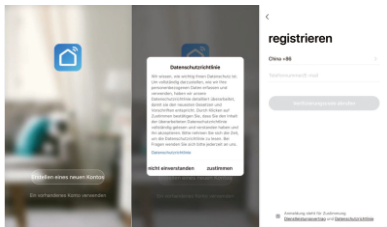

### Geräte-Normalmodus hinzufügen

Klicken Sie auf der Hauptseite oben rechts auf "+", um zum nächsten Seite zu gelangen und wählen Sie dann "Beleuchtung", wie unten gezeigt.

Vergewissern Sie sich im normalen Modus, dass das rote Licht des Geräts schnell blinkt und dann in den nächsten Schritt.



**Hinweis:**

Wenn das Licht nicht blinkt, drücken Sie die „Mode“-Taste des Controllers mit 5-10 Sekunden, damit das rote Licht beim Suchen und Verbinden schnell blinkt Netzwerk.

Wenn das Hinzufügen des Geräts im normalen Modus mehrmals fehlschlägt, versuchen Sie dann AP Modus.

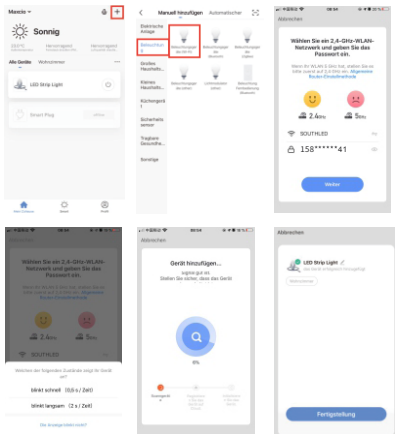
**AP-Modus**

Klicken Sie auf der Hauptseite oben rechts auf "+", um zum nächsten Seite zu gelangen und wählen Sie dann noch "Beleuchtung", wie unten gezeigt.

Klicken Sie im normalen Modus in der oberen rechten Ecke auf "Andere Methoden", um die Seite "AP Mode" fortzuführen.

Vergewissern Sie sich im AP-Modus, dass das rote Licht des Geräts langsam blinkt, und klicken Sie dann auf OK in den nächsten Schritt.

#### Hinweis:

Wenn das Licht schnell blinkt, drücken Sie einfach den Controller 5-10 Sekunden erneut, und das rote Licht blinkt langsam.

Wenn das Licht weder langsam noch schnell blinkt. Drücken Sie zuerst die Taste „Mode“ von die steuerung 5-10 Sekunden, um das rote Licht schnell zu blinken, Dann drücken Sie dann den Controller mit 5-10 Sekunden erneut bis das rote Licht langsam blinkt .

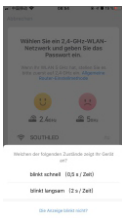
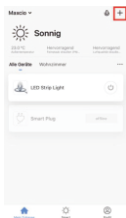

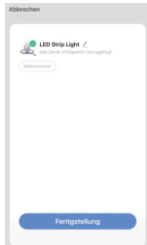
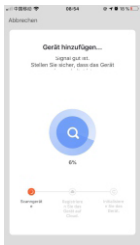
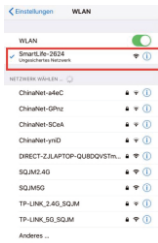
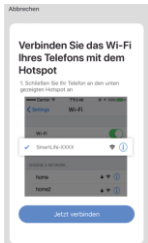

## Geräte Kontrolle

Nach der Verbindung der Geräte wird das entsprechende Smart-Gerät auf der Startseite angezeigt.

## Hinweis:

Wenn das Gerät offline ist, wird "Offline" angezeigt und kann nicht gesteuert werden.

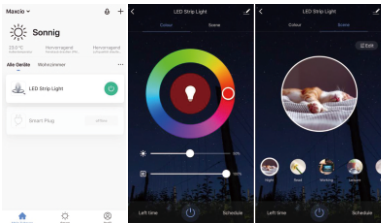

## LED-Streifenlicht mit Musikfunktion synchronisieren

Rufen Sie den Musikmodus auf und spielen Sie Musik mit einem Gerät ab. Die LED-Leiste wird mit Musik synchronisiert.

### Hinweis:

Die Lautstärke des Mobiltelefons ist relativ gering, es ist besser, Bluetooth-Audio zu verwenden.

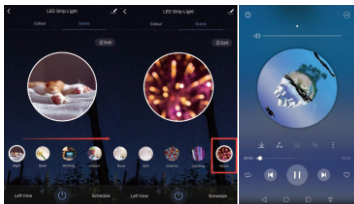

1. Klicken Sie oben rechts auf Bearbeiten, um eine benutzerdefinierte Szene aufzurufen.
2. Der Breath and Static Music-Modus eignet sich für Unterhaltungsmusik.
3. Der Flash-Musikmodus eignet sich für schnelle Rhythmusmusik.
4. Sie können die angezeigte Farbe hinzufügen / löschen / ändern und die Geschwindigkeit der Farbumschaltung ändern.
5. Wenn Sie nicht zufrieden sind, können Sie die Einstellungen zurücksetzen.

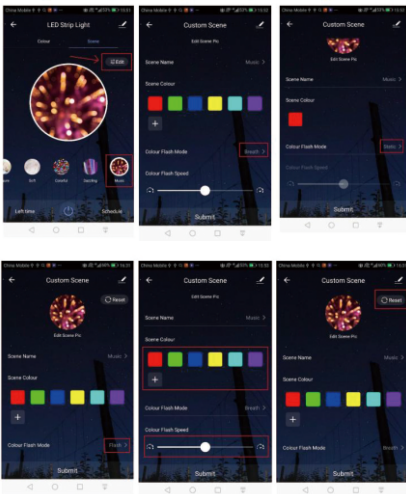

## Verbindung mit Amazon Alexa

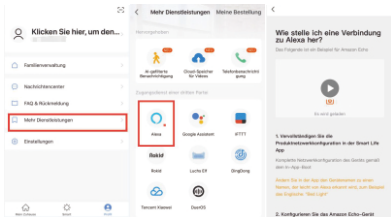

## Verbindung mit Google Assistant

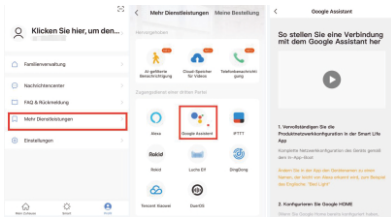

## FAQ

1. Wie herstelle ich den Controller wieder?

Drücken Sie die „Mode“-Taste des Controllers mit 5-10 Sekunden

2. Wie bekomme ich mehr Hilfe?

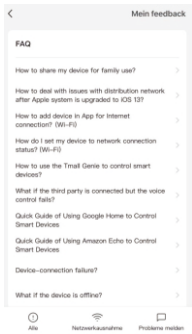
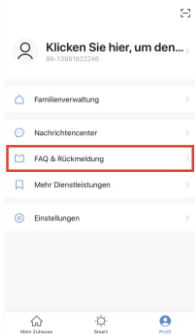

## Aufpassung:

- Bitte verwenden Sie das Produkt in einer trockenen Umgebung.
- Bitte verwenden Sie die Eingangsspannung bei 4,5-25V DC Spannung, darf nicht direkt an 220V AC angeschlossen werden.
- Das Produkt wird zum Anschluss einer gemeinsamen Anode angefordert. Die falsche Verbindung führt zu einer Fehlfunktion.
- Während des Produkt- und Software-Upgrades dienen die im Text aufgeführten Daten und Softwareschnittstellen nur zur Beschreibung und als Referenz. Bei Änderungen wird keine weitere Benachrichtigung angezeigt.

## Maxcio LED Ruban Musical WiFi

## La notice d'emploi

## Présentation du produit

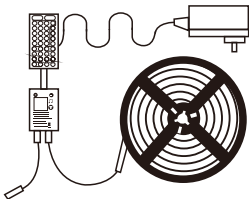

- \* Microphone MEMS intégré, acquisition de la musique et l'intensité sonore environnementale en temps réel
- \* LED ruban sync à la musique, contient une variété de modes rythmiques musicaux
- \* Contrôle via télécommande infrarouge (optionnel)
- \* LED rubans intelligentes avec une variété de couleurs et de modes qui peuvent être changés
- \* Contrôlé par l'application SmartLife
- \* Fonctionne avec Amazon alexa et Google home.

## Paramètres du produit

Catégorie	LED ruban musical wifi
Principe de contrôle	2.4G WiFi
Application	Smartlife, Tuya Smart
Capteur sonore	Microphone MEMS
Mode de fonctionnement LED	Tension constante: MOSFET
Tension d'entrée	DC (4,5-25) V
Puissance de sortie maximale	144W
Classement IP	IP20
Distance contrôlable via la télécommande	Distance visible 30M



## WiFi Controller Box

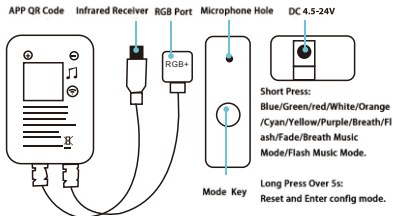

## IR Remote Controller

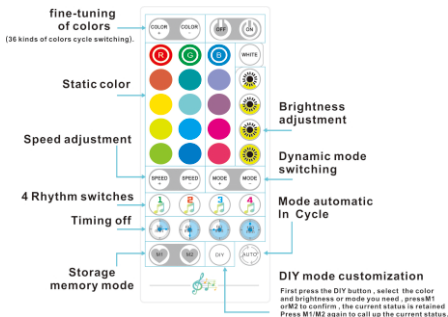

## Télécharger et installer l'application

\* Vous pouvez rechercher "Smart Life" dans APP Store ou Google Play pour télécharger. Ou vous pouvez scanner le code QR ci-dessous pour le télécharger.



\* Entrer le compte

Si vous êtes un nouvel utilisateur, s'il vous plaît enregistrer un compte.

\* Fonctionner l'application:

Assurez-vous que le ruban et smartphone sont dans la même couverture de réseau 2.4G WIFI, et connectez la bande lumineuse à l'alimentation.

\* Il existe deux façons de se connecter à smartlife.

A. Mode par défaut:

1. Assurez-vous que le ruban est rouge et clignote rapidement.
2. Dans la page principale de l'application smartlife, cliquez sur le coin supérieur droit "+" ou "Ajouter" pour entrer la fenêtre suivante.
3. Puis sélectionner "Éclairage" et "Dispositifs d'éclairage", veuillez cliquer "Voyant de confirmation dans le flash", et puis entrez le mot de passe wifi et confirmez.
4. Une fois la configuration terminée, le bande led cesse de clignoter. veuillez modifier le nom de l'appareil.

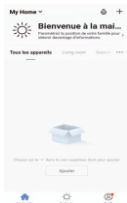

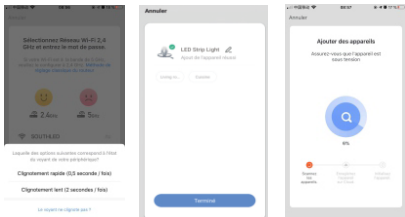

## B. Deuxième méthode de connexion (Mode AP)

1. Lorsque le ruban led clignote rapidement, appuyez et maintenez la touche "Mode" du capteur pendant 5 à 10 secondes jusqu'à ce que la led (Rouge) clignote lentement.
2. Sélectionnez "Éclairage" et "Dispositifs d'éclairage", Cliquez sur "Autre méthode" et "Mode AP" pour entrer dans l'interface de configuration AP. Puis cliquez sur "À la lumière de confirmation clignote lentement" pour sélectionner le WIFI connecté au téléphone actuel et entrez le mot de passe WIFI et cliquez sur "confirmer".

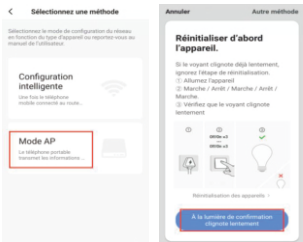

1. Cliquez sur "se connecter maintenant", va sauter la page liste WIFI, sélectionnez Smart Life-XXXX", puis de nouveau à l'APP.

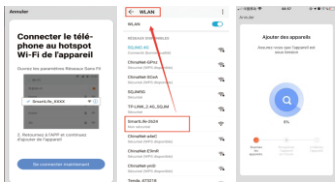

2. Une fois la configuration terminée, le bande led cesse de clignoter. veuillez modifier le nom de l'appareil.

### Fonction de synchronisation de la bande LED avec la musique

\* Passez en mode musique et jouer de la musique avec n'importe quel appareil. Le ruban led se synchronisera avec la musique.

\* Note:

La taille du téléphone est relativement petit, il est préférable d'utiliser l'audio Bluetooth.

1. Cliquez sur "Edit" dans le coin supérieur droit pour entrer dans "Custom Scene".
2. Breath et Static convient à la musique légère.
3. Flash convient à la musique rythmique rapide.
4. Vous pouvez ajouter / supprimer / modifier la couleur affichée et changer la vitesse de changement de couleur.
5. Si vous n'êtes pas satisfait, vous pouvez réinitialiser les paramètres.

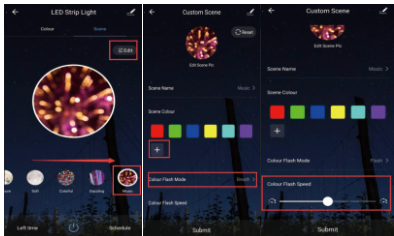

## Fonctionne avec Amazon Alexa

The image shows two screenshots related to connecting the LED Strip Light to Amazon Alexa. The left screenshot is from the Smart Life app, showing the 'LED Strip Light' control screen with a color wheel and a red box highlighting the 'Alexa' icon in the top right corner. The right screenshot is from the Amazon Alexa app, showing the 'Informations appareil' menu with 'Alexa' highlighted in a red box. To the right of this is the 'amazon alexa' app interface, which includes a 'Se connecter avec Amazon' button and a link to 'Consultez les instructions de connexion dans l'application Alexa'.

## Fonctionne avec Google Assistant

The image shows two screenshots related to connecting the LED Strip Light to Google Assistant. The left screenshot is from the Smart Life app, showing the 'Google Assistant' icon highlighted in a red box. The right screenshot is from the Google Assistant app, showing the 'Come connettersi all' Google Assistant' screen with a play button and instructions in Italian: '1. Completare i prodotti di configurazione di rete nella App di Smart Life. Configurazione completa della rete del dispositivo in base alla guida in App. Commento: Nell'app, modificare il nome del dispositivo che può essere facilmente identificato da Alexa, di solito in inglese come "bed room".' Below this is the instruction '2. Configurare Google HOME'.

### Attentions:

1. Veuillez utiliser le produit dans un environnement sec.
2. La tension d'entrée est de 4.5-25 V DC et ne doit pas être directement connectée à 220 V AC.
3. Le produit est demandé une connexion d'anode commune. Une mauvaise connexion provoquera un dysfonctionnement.
4. Lors du processus de mise à niveau du produit et du logiciel, les captures d'écran d'applications et de données répertoriées dans cet article sont fournies à titre indicatif uniquement. Aucune autre notification ne sera donnée en cas de changement.

### Questions - réponses:

1. Comment réinitialiser le ruban led?

Appuyez sur la touche "Mode" du capteur avec 5-10 secondes.

### 3. Comment obtenir plus d'aide?

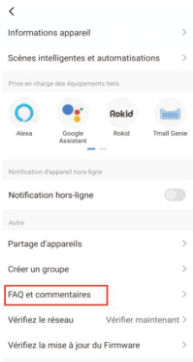

# Manual de Usuario

## Partes del Producto

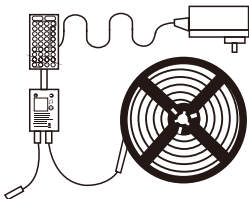

1. Micrófono MEMS incorporado, adquiere en tiempo real a la música y la intensidad del sonido.
2. LED tira de luz se sincroniza con música que contiene una variedad de modos de ritmo musical.
3. Control remoto por infrarrojos (opcional).
4. El teclado puede convertir colores y modos.
5. Control por "Smart Life"
6. Trabaja con Amazon alexa y Google home, etc.

## Parámetros del Producto

Categoría	LED Tira de Luz
Principio de dominación	WiFi
APP	Smart Life
Idioma	Chino, Inglés
Plataforma de operaciones	Android4.0 o IOS9.0 o superior
Sensor de sonido	MEMS MIC
Tipo de accionamiento LED	Voltaje constante: MOSFET
Canales	3
Voltaje de entrada	DC (4.5-25) V
Potencia de salida máxima	144W
Trabaja para	Tiras LED u otras luces de voltaje constante
Método de conexión	Ánodo Común
Clasificación del IP	IP20
Distancia de control	30M (interior)

## WiFi Controller Box

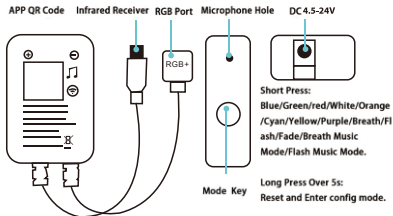

## IR Remote Controller

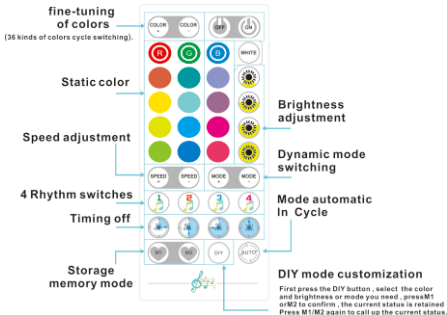



## Manual de Software

### Descargue e Instale la Aplicación

Use su móvil para escanear el código QR a continuación o busque "Smart Life" en el marcador de la aplicación para descargar e instalar la aplicación



### Crear una cuenta nueva/Iniciar sesión/Olvidar la contraseña

**Crear una cuenta:** Cree una cuenta con los siguientes pasos antes de usarla por primera vez. Si tiene una cuenta, ingrese la contraseña para iniciar sesión directamente.

**Iniciar sesión:** Ingrese el número de cuenta y la contraseña correcta para iniciar sesión.

**He olvidado la contraseña:** Puede ir a la página de inicio de sesión para recuperar su contraseña.

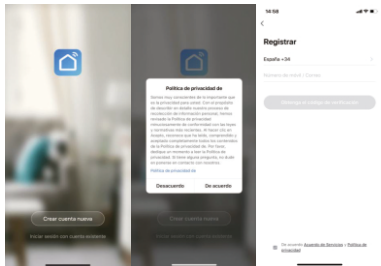

## Añadir Dispositivo-Modo Normal

Abra la aplicación "Smart Life" e inicie sesión en su cuenta. Toque el ícono "+" en la esquina superior derecha para seleccionar el tipo de dispositivo; toque "Iluminación" y elija "Dispositivos de iluminación(Wi-Fi)".

En modo normal, confirme que la luz roja del dispositivo parpadea rápidamente y luego pasa al siguiente paso.

### Nota:

Si la luz no parpadea, presione el botón "mode" del controlador con 5-10 segundos para mantener la luz roja en el parpadeo rápido.

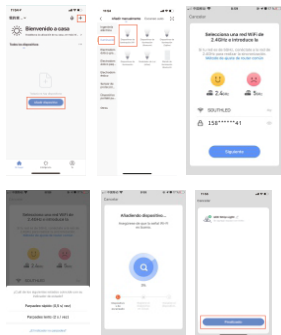

Si agrega el dispositivo en modo Normal falla muchas veces, vaya a "Otros modos", elija "Conectarse a la red mediante un punto de acceso".

### Añadir Dispositivo-Modo AP

Si no puede configurar correctamente el modo predeterminado, intente conectarse al modo AP. Toque "otros modos" en la esquina superior derecha y elija "Conectarse a la red mediante un

punto de acceso\*.

- Presione "En la confirmación...parpadea lentamente".
- Ingrese la contraseña de Wi-Fi.
- Abra la configuración de WLAN y conéctese con "Smart Life- xxxx".

**Nota:**

Si la luz parpadea rápidamente, solo presione el botón "mode" del controlador con 5-10 segundos nuevamente, y la luz roja parpadeará lentamente.

Si la luz no parpadea lentamente ni parpadea rápidamente. Primero presionea "mode" del controlador con 5-10 segundos para mantener la luz roja en el parpadeo rápido, luego suelte el botón y presione con 5-10 segundos nuevamente , la luz roja parpadea lentamente.

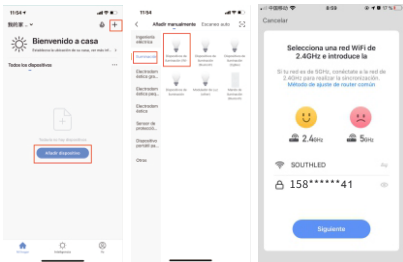

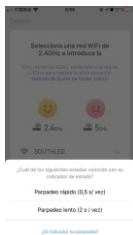

## Cómo controlar el dispositivo

Después de conectarse con éxito, el dispositivo se mostrará en la página de inicio. Toque para ingresar a la página de control.

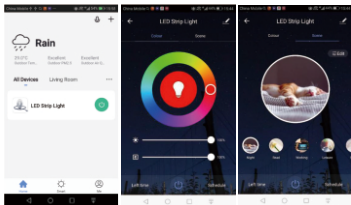

## LED Tira de luz se sincroniza con ritmo musical

Entra al modo de música y reproduce música con cualquier dispositivo, la luz de tira LED se sincronizará con el ritmo de la música.

### Nota:

El volumen del móvil es relativamente pequeño, es mejor usar Bluetooth.

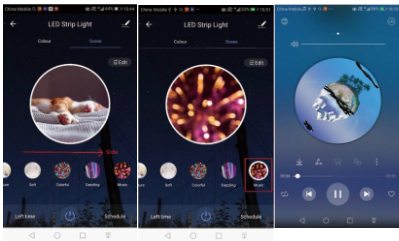

1. Toque "Edit" en la esquina superior derecha para entrar a la escena personalizada.
2. Modo "Breath" y "Static" es adecuado para música ligera.
3. Modo "Flash" es adecuado para música de ritmo rápido.
4. Puede añadir / eliminar / modificar el color que se muestra y cambiar la velocidad de cambio de color.
5. Si no está satisfecho, puede restablecer la configuración.

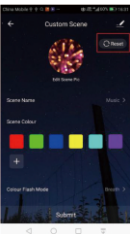
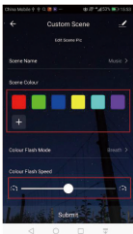
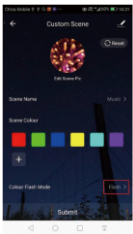
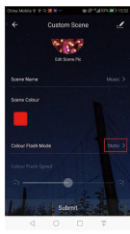
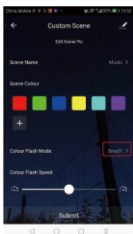
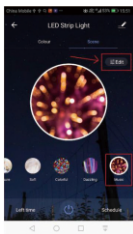

## Trabaja con Amazon Alexa

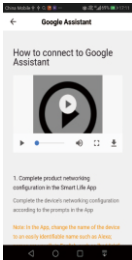
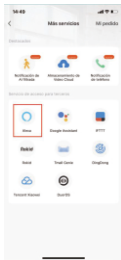
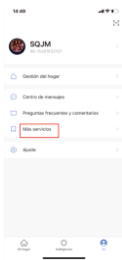

## Trabaja con Google Assistant

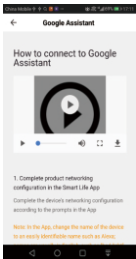
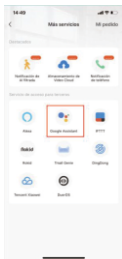
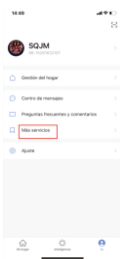

## FAQ

## 1. ¿Cómo restablecer el controlador?

Presione el botón "mode" del controlador con 5-10 segundos

## 2. ¿Cómo obtener más ayuda?

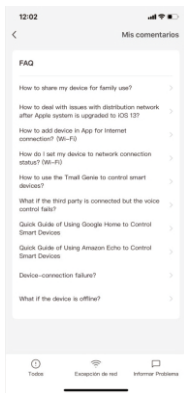
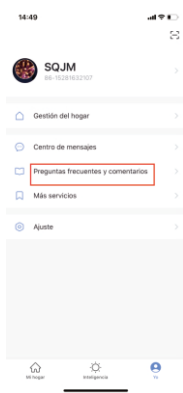

## Atenciones

1. Use el producto en un lugar seco.
2. Use el voltaje de entrada de 4.5-25V DC, no conecta directamente a 220V AC.
3. Este producto requiere una conexión de óndodo común. Un error de conexión puede causar un mal funcionamiento.
4. En el proceso de actualización del producto y el software, la interfaz de datos y software que figura en el texto es solo para descripción y referencia. No se notificará más si hay algún cambio.



## Maxcio Striscia LED Musicale WiFi

### Manuale di istruzioni

#### Introduzione del prodotto:

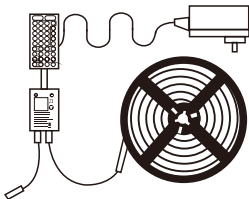

1. Microfono MEMS incorporato, acquisizione della musica e intensità del suono ambientale in tempo reale
2. Le strisce luminose WiFi si sincronizzano con la musica e includono più pattern ritmici musicali
3. Controllo tramite telecomando a infrarossi (opzionale)
4. Strisce LED intelligenti con una varietà di colori e modalità che possono essere cambiati
5. Controllo tramite SmartLife APP
6. Funziona con Amazon Alexa e Google Home

#### Parametro del prodotto

Categoria	striscia LED musicale WiFi
Principio di controllo	2.4G WiFi
Applicazione	Smartlife, Tuya Smart
Sensore del suono	MEMS microfono
Modalità operativa LED	Tensione costante: MOSFET
Tensione di ingresso	DC (4.5-25) V
Potenza massima in uscita	144W
Classifica IP	IP20
Distanza controllabile tramite telecomando	Distanza visibile 30M

## WiFi Controller Box

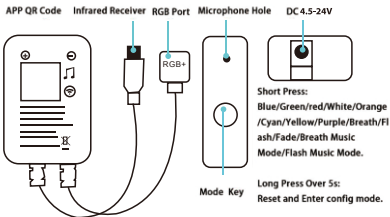

## IR Remote Controller

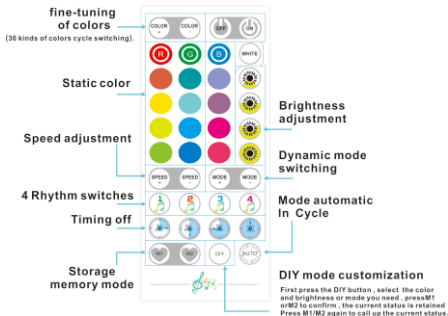

## Scaricare e installare l'applicazione

\* Puoi cercare "Smart Life" in APP Store o Google Play per il download.



\* Inserisci l'account

Se sei un nuovo utente, registra un account (la regione devi scegliere Italy)

\* Progetta l'applicazione:

Accertarsi che la striscia led e lo smartphone siano nella stessa copertura di rete Wi-Fi 2.4G e collegare la striscia led alla fonte di alimentazione.

1. Passi di collegamento:

\* Aggiungere un nuovo dispositivo, nella pagina principale dell'app smartlife, fai clic sull'angolo in alto a destra "+".

\* Collegare prima il tuo telefono al Wi-Fi locale (WiFi a 2,4 GHz)

\* Premere il pulsante "Mode" del sensore per 5-10 secondi, fino a quando la striscia led è rosso e lampeggia rapidamente.

\* Nell'app Smart Life, premere "+" nella home page e selezionare "illuminazione" et "Dispositivi di illuminazione".

\* Fare clic sulla "Conferma che l'indicatore led lampeggi velocemente", quindi inserire la password wifi e confermare.

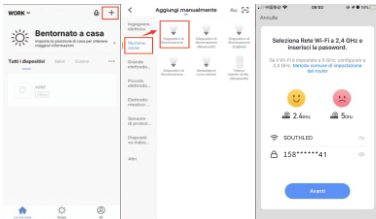

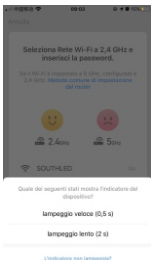

## 2. Secondo metodo di connessione (modalità AP)

- \* Premere il pulsante "Mode" del sensore per 5-10 secondi, fino a quando la striscia led è rosso e lampeggia lentamente.
- \* Clicca "Altrimenti", seleziona la "modalità dell'app", accendere "Conferma che la spia led lampeggi lentamente".

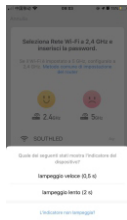
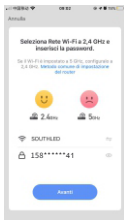

- \* Inserisci la password Wi-Fi per entrare nella tua rete.
- \* Fare clic su "Connettere ora", salterò la pagina di elenco Wi-Fi, selezionare "Smart Life-XXXX", e quindi di nuovo all'APP.

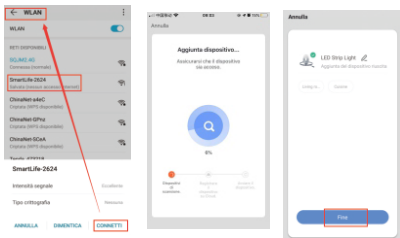

\* Attendere il completamento della connessione, e modifica il nome del dispositivo.

### Funzione di sincronizzazione della striscia LED con musica

\* Passa alla modalità musica e riproduci musica con qualsiasi dispositivo. Il striscia led si sincronizzerà con la musica.

1. Fai clic su "Edit" nell'angolo in alto a destra per accedere a "Custom Scene".
2. Breath and Static è adatto per la musica leggera.
3. Flash è adatto per musica dal ritmo frenetico.
4. È possibile aggiungere / eliminare / cambiare il colore visualizzato e cambiare la velocità di cambio colore.
5. Se non si è soddisfatti, è possibile ripristinare le impostazioni.

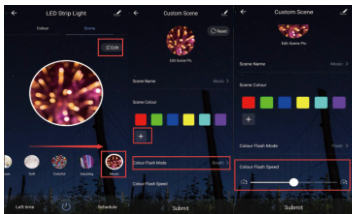

## Funziona con Amazon Alexa

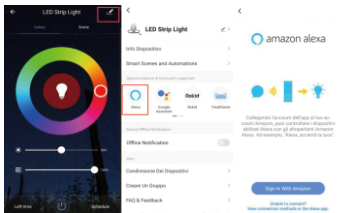

## Funziona con Google Assistant

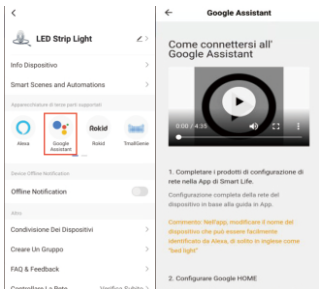

### FAQ

#### 1. Come resettare il controller?

Premere il tasto "mode" del sensore per 5-10 secondi

#### 2. Come ottenere più aiuto?

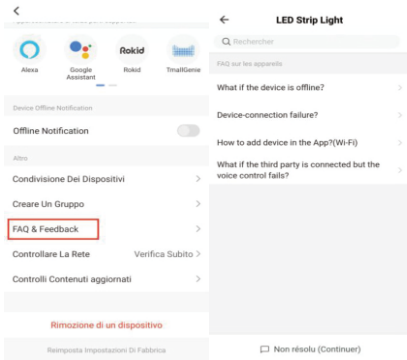

If you still have questions, please feel to contact us.